

End Flange Dimensions - ASME 16.5, 1996

Valve Size	ASME Class 150 Raised Face (in mm)						ASME Class 300 Raised Face (in mm)							
	A Ø	B Ø	C Ø	D*	E Ø	Bolt		A Ø	B Ø	C Ø	D*	E Ø	Bolt	
						No.	Dia						No.	Dia
50 (2")	152	120	92	19.1 (15.9)	19	4	5/8"	165	127	92	22.3	19	8	5/8"
65 (2 1/2")	178	139	105	22.3 (17.5)	19	4	5/8"	190	149	105	25.4	22	8	3/4"
80 (3")	190	152	127	23.9 (19.1)	19	4	5/8"	210	168	127	28.6	22	8	3/4"
100 (4")	229	190	157	23.9	19	8	5/8"	254	200	157	31.8	22	8	3/4"
125 (5")	254	216	186	23.9	22	8	3/4"	279	235	186	35.0	22	8	3/4"
150 (6")	279	241	216	25.4	22	8	3/4"	318	270	216	36.6	22	12	3/4"
200 (8")	343	298	270	28.6	22	8	3/4"	381	330	270	41.3	25	12	7/8"
250 (10")	406	362	324	30.2	25	12	7/8"	444	387	324	47.7	29	16	1"
300 (12")	483	432	381	31.8	25	12	7/8"	521	451	381	50.8	32	16	1 1/8"
350 (14")	533	476	413	35.0	29	12	1"	584	514	413	54.0	32	20	1 1/8"
400 (16")	597	539	470	36.6	29	16	1"	648	571	470	57.2	35	20	1 1/4"
450 (18")	635	578	533	39.7	32	16	1 1/8"	711	628	533	60.4	35	24	1 1/4"
500 (20")	698	635	584	42.9	32	20	1 1/8"	775	686	584	63.5	35	24	1 1/4"
600 (24")	813	749	692	47.7	35	20	1 1/4"	914	813	692	69.9	41	24	1 1/2"

* Inclusive of raised face 1.6mm (0.06") each. Dimensions within brackets are for integral flanges

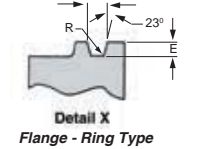
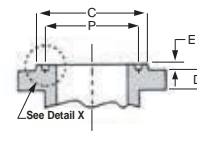
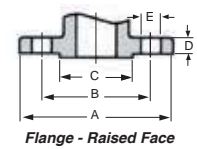

Large-sized End Flange Dimensions as per ASME 16.47, 1996 Series A (MSS SP 44)

ASME Class	Valve Size	A Ø	B Ø	C Ø	D*	E Ø	Bolt	
							No.	Dia
CL. 150	700 (28")	927	864	800	71	35	28	1 3/8"
	750 (30")	984	914	857	75	35	28	1 3/8"
	850 (34")	1111	1029	965	83	41	32	1 1/2"
	900 (36")	1168	1086	1022	90	41	32	1 1/2"
	1050 (42")	1346	1257	1194	97	41	36	1 1/2"
CL. 300	1200 (48")	1511	1422	1359	108	41	44	1 1/2"
	750 (30")	1092	997	857	95	48	28	1 3/4"

* Inclusive of raised face 1.6mm (0.06") each.

Large-sized End Flange Dimensions as per ASME 16.47, 1996 Series B (API 605)

ASME Class	Valve Size	A Ø	B Ø	C Ø	D*	E Ø	Bolt	
							No.	Dia
CL. 150	700 (28")	837	795	762	48	22	40	3/4"
	750 (30")	887	846	813	51	22	44	3/4"
	850 (34")	1005	957	921	57	25	40	7/8"
	900 (36")	1057	1010	972	59	25	44	7/8"
	1050 (42")	1226	1171	1130	68	28	48	1"
CL. 300	1200 (48")	1392	1335	1289	75	28	44	1 1/8"
	750 (30")	991	921	845	94	41	36	1 3/8"

* Inclusive of raised face 1.6mm (0.06") each.

Valve Size	ASME Class 600 Raised Face (in mm)					Bolt	
	A Ø	B Ø	C Ø	D	E Ø	Bolt	
						No.	Dia
50 (2")	165	127	92	25.4	19	8	5/8"
65 (2 1/2")	190	149	105	28.6	22	8	3/4"
80 (3")	210	168	127	31.8	22	8	3/4"
100 (4")	273	216	157	38.1	25	8	7/8"
125 (5")	330	266	186	44.5	29	8	1"
150 (6")	356	292	216	47.7	29	12	1"
200 (8")	419	349	270	55.6	32	12	1 1/8"
250 (10")	508	432	324	63.5	35	16	1 1/4"
300 (12")	559	489	381	66.7	35	20	1 1/4"
350 (14")	603	527	413	69.9	38	20	1 3/8"
400 (16")	686	603	470	76.2	41	20	1 1/2"
450 (18")	743	654	533	82.6	45	20	1 5/8"
500 (20")	813	724	584	88.9	45	24	1 5/8"
600 (24")	940	838	692	102.0	51	24	1 7/8"

Height of raised face is 6.4 mm (0.25") each.

Valve Size	ASME Class 600 Ring Type (in mm)									
	A Ø	B Ø	C Ø	D	Grv. No.	Pitch Ø - P	Depth E	Width F	Bottom Rad. R	
										50 (2")
65 (2 1/2")	190	149	127	28.6	R26	100	8.0	12.0	0.76	
80 (3")	210	168	146	31.8	R31	124	8.0	12.0	0.76	
100 (4")	273	216	171	38.1	R37	150	8.4	8.7	0.76	
125 (5")	330	266	209	44.5	R41	181	8.0	12.0	0.76	
150 (6")	356	292	241	47.7	R45	211	8.0	12.0	0.76	
200 (8")	419	349	302	55.6	R49	270	8.0	12.0	0.76	
250 (10")	508	432	366	63.5	R53	324	8.0	12.0	0.76	
300 (12")	559	489	413	66.7	R57	381	8.0	12.0	0.76	
350 (14")	603	527	457	69.9	R61	419	8.0	12.0	0.76	
400 (16")	686	603	508	76.2	R65	470	8.0	12.0	0.76	
450 (18")	743	654	575	82.6	R69	533	8.0	12.0	0.76	
500 (20")	813	724	635	88.9	R73	584	9.5	13.5	1.52	
600 (24")	940	838	749	101.6	R77	692	11.1	16.6	1.52	

Height of raised face is 6.4 mm (0.25") each. Grv. - Groove

Valve Size	ASME Class 900 Raised Face (in mm)					Bolt	
	A Ø	B Ø	C Ø	D	E Ø	Bolt	
						No.	Dia
50 (2")	216	165	92	38.1	25.4	8	7/8"
65 (2 1/2")	244	191	105	41.1	28.4	8	1"
80 (3")	241	191	127	38.1	25.4	8	7/8"
100 (4")	292	235	157	44.5	31.8	8	1 1/8"
125 (5")	349	279	186	50.8	35.1	8	1 1/4"
150 (6")	381	318	216	55.6	31.8	12	1 1/8"
200 (8")	470	394	270	63.5	38.1	12	1 3/8"
250 (10")	546	470	324	69.9	38.1	16	1 3/8"
300 (12")	610	533	381	79.2	38.1	20	1 3/8"

Height of raised face is 6.4 mm (0.25") each.

Valve Size	ASME Class 900 Ring Type (in mm)									
	A Ø	B Ø	C Ø	D	Grv. No.	Pitch Ø - P	Depth E	Width F	Bottom Rad. R	
										50 (2")
65 (2 1/2")	244	191	137	41.1	R27	108	8.0	12.0	0.76	
80 (3")	241	191	146	38.1	R31	124	8.0	12.0	0.76	
100 (4")	292	235	171	44.5	R37	149	8.0	12.0	0.76	
125 (5")	349	279	209	50.8	R41	181	8.0	12.0	0.76	
150 (6")	381	318	241	55.8	R45	211	8.0	12.0	0.76	
200 (8")	470	394	308	63.5	R49	270	8.0	12.0	0.76	
250 (10")	546	470	362	69.9	R53	324	8.0	12.0	0.76	
300 (12")	610	533	419	79.2	R57	381	8.0	12.0	0.76	

Height of raised face is 6.4 mm (0.25") each. Grv. - Groove

Valve Size	ASME Class 1500 Raised Face (in mm)					Bolt	
	A Ø	B Ø	C Ø	D	E Ø	Bolt	
						No.	Dia
50 (2")	216	165	92	38.1	25.4	8	7/8"
65 (2 1/2")	244	191	105	41.1	28.4	8	1"
80 (3")	267	203	127	47.8	31.8	8	1 1/8"
100 (4")	311	241	157	53.8	35.1	8	1 1/4"
125 (5")	375	292	186	73.2	41.1	8	1 1/2"
150 (6")	394	318	216	82.6	38.1	12	1 3/8"
200 (8")	483	394	270	91.9	44.5	12	1 3/8"
250 (10")	584	483	324	108.0	50.8	12	1 7/8"
300 (12")	673	572	381	124.0	53.8	16	2"

Height of raised face is 6.4 mm (0.25") each.

Valve Size	ASME Class 1500 Ring Type (in mm)									
	A Ø	B Ø	C Ø	D	Grv. No.	Pitch Ø - P	Depth E	Width F	Bottom Rad. R	
										50 (2")
65 (2 1/2")	244	191	137	41.1	R27	108	8.0	12.0	0.76	
80 (3")	241	191	146	38.1	R31	124	8.0	12.0	0.76	
100 (4")	292	235	171	44.5	R37	149	8.0	12.0	0.76	
125 (5")	349	279	209	50.8	R41	181	8.0	12.0	0.76	
150 (6")	381	318	241	55.8	R45	211	8.0	12.0	0.76	
200 (8")	470	394	308	63.5	R49	270	8.0	12.0	0.76	
250 (10")	546	470	362	69.9	R53	324	8.0	12.0	0.76	
300 (12")	610	533	419	79.2	R57	381	8.0	12.0	0.76	

Height of raised face is 6.4 mm (0.25") each. Grv. - Groove